



DSDBOX

Digital Screen Display

23 & 9.7 INCH

STYLISH PRODUCT SHOWCASE

01 DSD BOX

WHAT IS DSD BOX?

An innovative and engaging way to show off a physical product using cutting edge video screen technology.

HOW DOES IT WORK?

Unlike regular LCD screens, the screens in DSD Box are SEE THROUGH! It plays video just as you would expect but because it is transparent you can see the product behind the screen!

WHY DSD BOX?

It is new, engaging, fuses Physical & Digital and will grab attention and stop people in their tracks without fail.

POTENTIAL APPLICATIONS

- Retail / Point of sale
- Pubs / restaurants / bars
- Cinema
- Shop Window displays
- Trade show displays
- Counter displays
- Museums / galleries
- Office reception areas

DSD Box 23 INCH



DSD Box 9.7 INCH

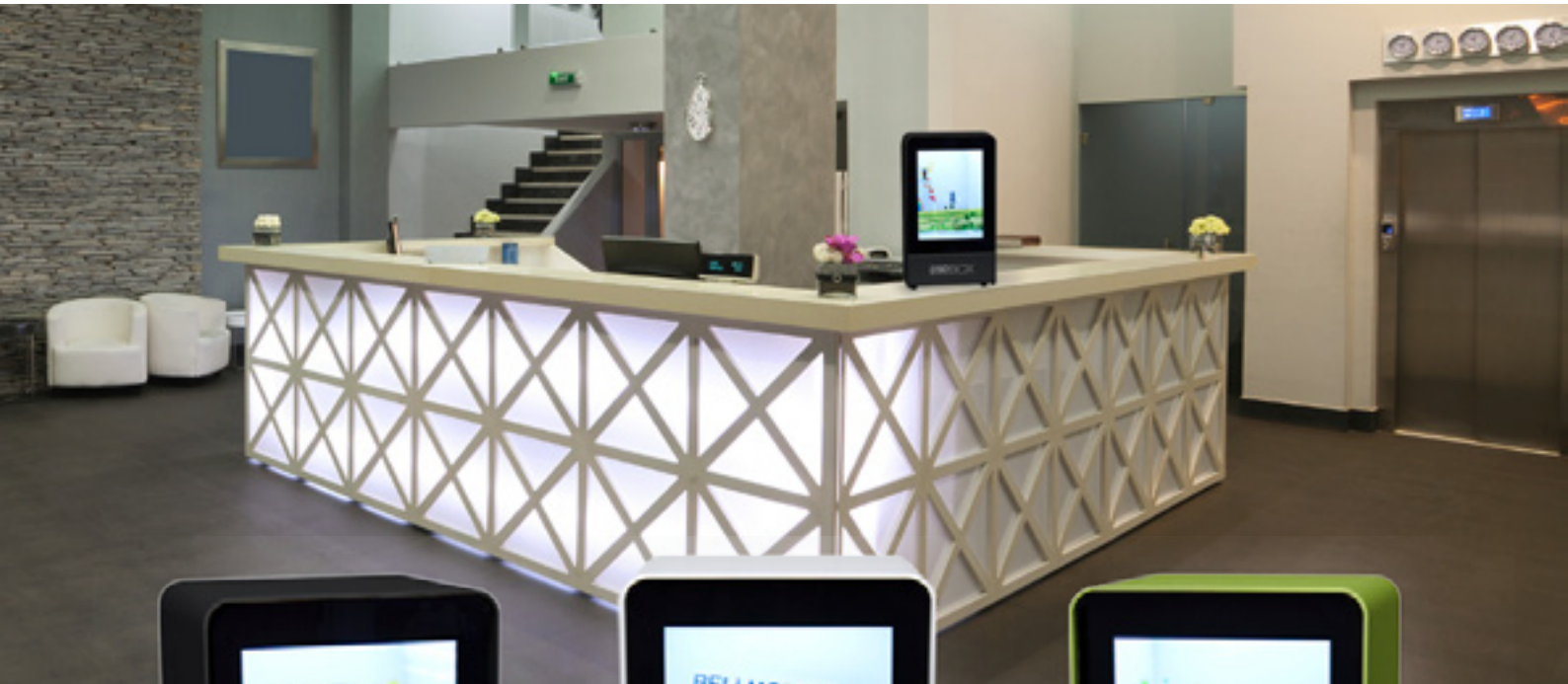

02 PRODUCT INFO

DSD Box 23 inch

Product dimensions: 435mm (H) x 575mm (W) x 356mm (D)

Screen Size : 23inch Transparent LCD

Product Weight: 16kg

Case Material : Aluminum

LED: High bright white LED * 72EA

Speaker: 2W x 2EA (Option)

DSD Box 9.7 inch

Product dimensions: 345mm (H) x 200mm (W) x 170mm (D)

Screen Size : 9.7inch Transparent LCD

Inner dimensions for product: approx 210mm (H) x 160mm (W) x 140mm (D)

Product Weight: 5.5kg

Case Material : Aluminum

LED: High bright white LED * 72EA

Speaker: 2W x 2EA (Option)



FRONT VIEW

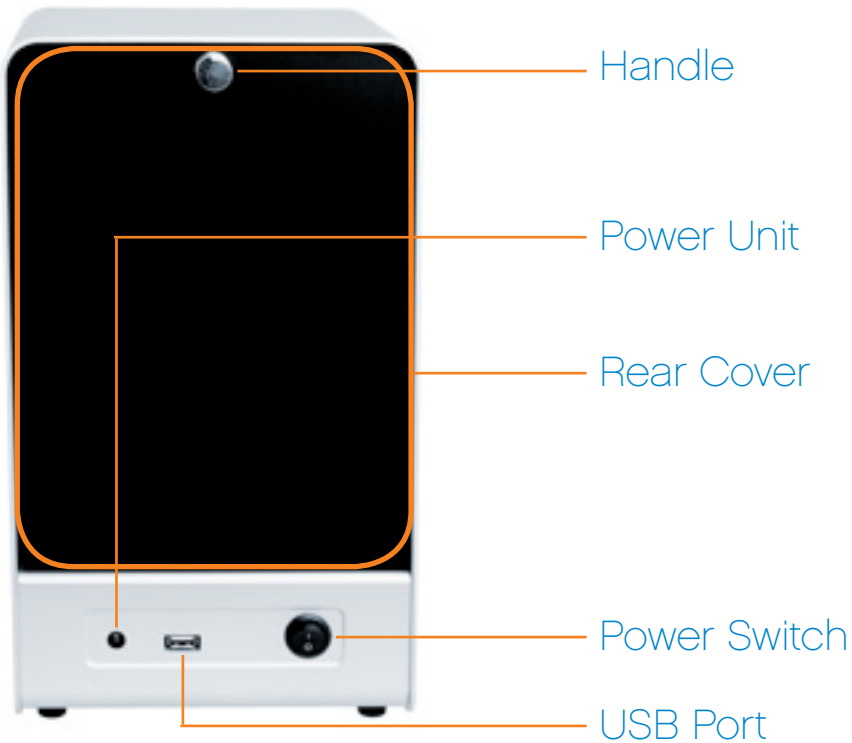

REAR VIEW

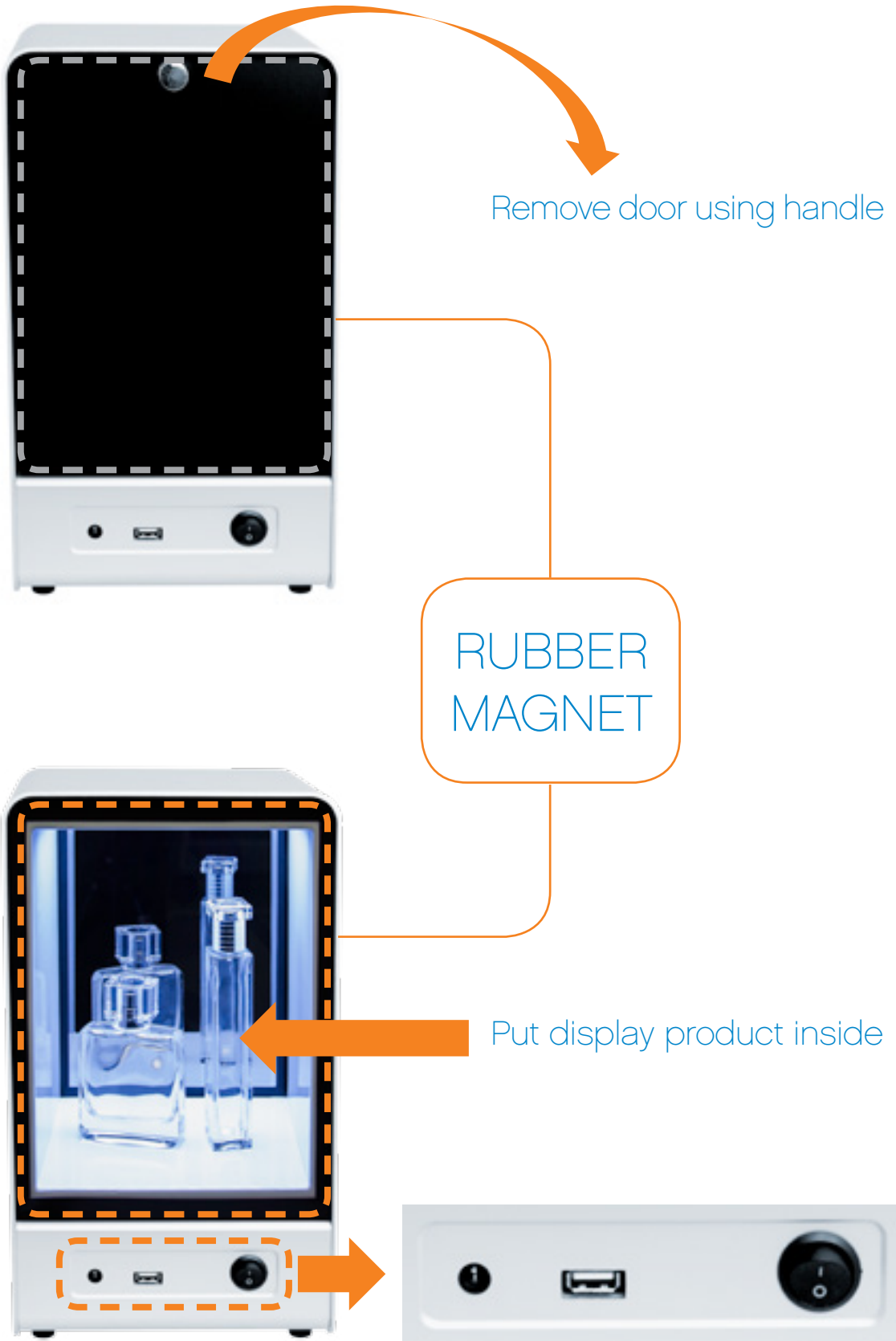

* 9.7inch unit shown in illustration. The concept is the same for the 23inch unit.

03 OPERATION

STEP 1

Connect power cable to power leads

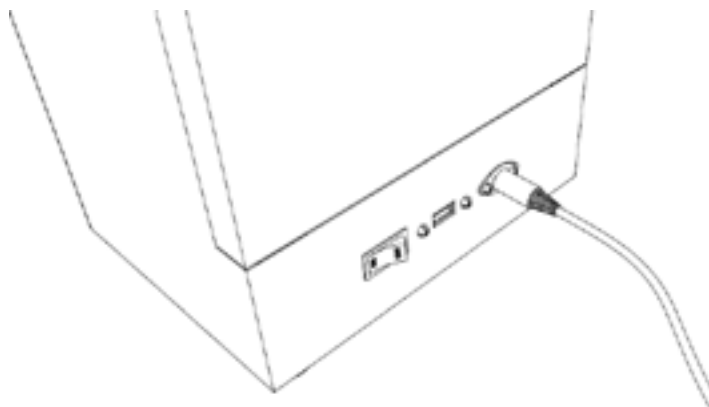

STEP 2

Insert USB memory and press power button

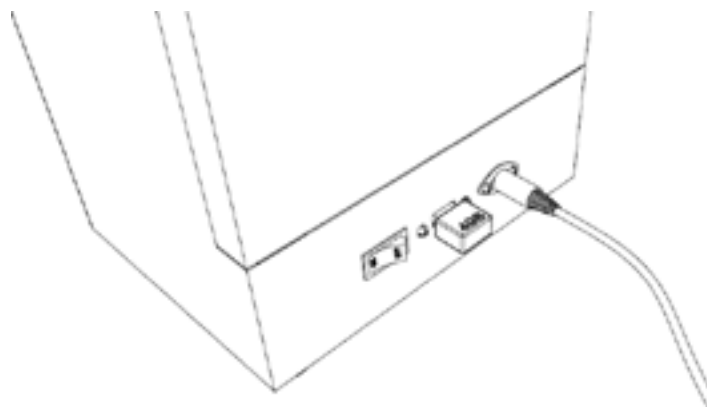

23" SCREEN VIDEO FORMAT

- Ensure the video file is created in landscape format
- Resolution: 1680 x 1050 px, 30 fps
- Support Codec: MP4, AVI
- If the video file has higher resolution or different codec, please re-create to the correct format



LANDSCAPE ✓

9.7" SCREEN VIDEO FORMAT

- Ensure the video file is created in portrait format
- Resolution: 480 x 640 px, 30 fps
- Support Codec: MP4, AVI
- If the video file has higher resolution or different codec, please re-create to the correct format

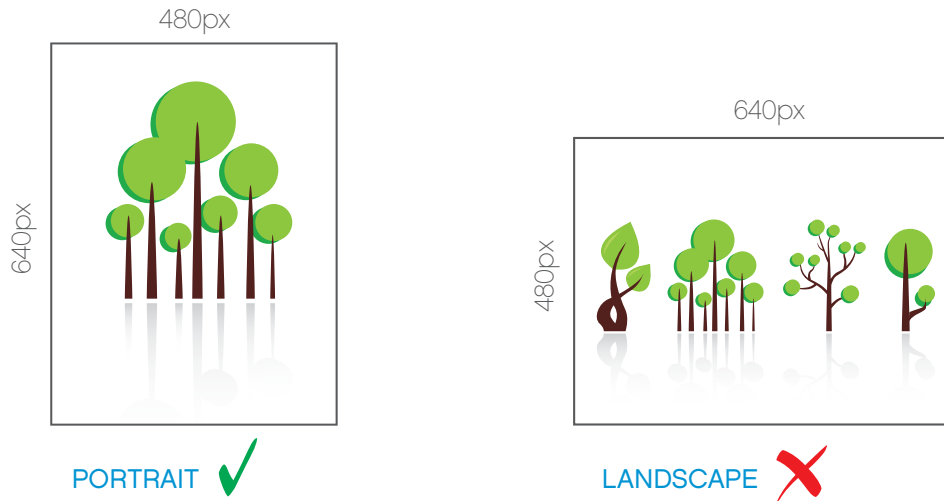

PUTTING A VIDEO FILE ON TO THE DSD BOX

1. Create a new folder called “**__autoplay** “ on a **FAT32** formatted USB.
2. Place the AVI files that you’d like to install in the “**__autoplay**“ folder.
3. Insert the USB in the port at the rear of the unit and it will auto copy the files (assuming the video files are created to the correct spec).
4. Once the auto copy is complete, pull out the USB.



☎ 0044 (0) 20 7940 6800

sales@amstoreinnovation.com

www.amstoreinnovation.com